

NOTES:

1. SPECIFICATIONS

- . Switch Function: Single Pole Single Throw
- . Contact Rating: 50mA at 12Vdc
- . Insulation Resistance: 100MΩ min.
- . Contact Resistance: 100mΩ max.
- . Operating Life: 100,00 cycles

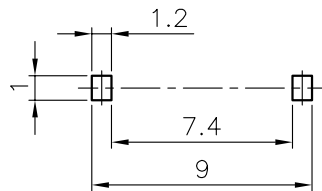
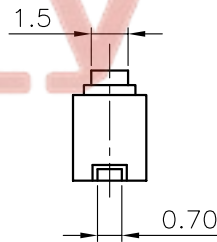
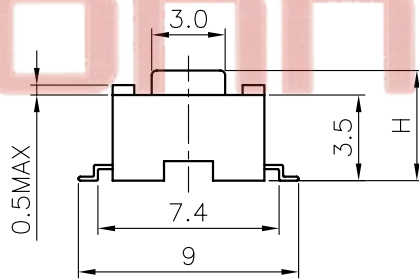
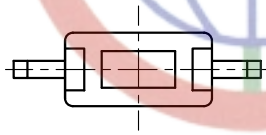

Recommend PCB layout  
Tolerance ±0.05

CIRCUIT DIAGRAM

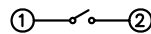

REV.	DESCRIPTION	DRAWN	CHECKED	APPROVED
A	NEW RELEASE	LL 12/15/06		

- . Stop Strength: Place The Switch Such That Vertical, A Static Load Of 3Kgf Shall Be Applied In The Direction
- . Operation Temperature Range: -25°C to +70°C
- . Wave Soldering: Recommended Solder Temperature At 500°F(260°C)max. 5 Seconds, Subject To pcb 1.6mm Thickness.
- . Hand Soldering: Use Soldering Iron Of 30 Watts, Controlled At 608°F(320°C) Approximately 2 Seconds.

2. PRODUCT NUMBER CODE:

DS1109-01 - X X X X X

- Packing type  
B: tube A: polybag  
R: tape & reel
- Actuator color  
L: blue K: black N: brown R: red  
Y: yellow
- Housing color  
L: blue K: black N: brown R: red  
Y: yellow
- Profile Height(DIM. H)  
1: 4.3mm 2: 5.0mm 3: 7.0mm  
4: 7.3mm 5: 9.5mm 6: 13.0mm
- Size  
2: 3mm\*6mm

Tel: 86-574-6350878

Fax: 86-574-63510817

GENERAL TOLERANCE		ANGLE TOLERANCE		PROJECTION		TITLE
X. ±0.60	.X ±0.38	.X ±5°	.XX ±3°	UNITS	mm	TACT SWITCH DIP TYPE 3mmX6mm
.XX ±0.25		.XX ±2°		SHEET SIZE	A4	SERIES DS1109-01
DRAWING TYPE	CUSTOMER		晨翔电子有限公司 Add.: West Jiaom Road, Cixi Jiaxing P.C. 315321			
SCALE	1:1	SHEET	1 OF 1	CONNFLY CONNFLY ELECTRONIC CO. LTD		
DRAWING NO.	C-DS1109-01-2XXXX					

REV.	DESCRIPTION	DRAWN	CHECKED	APPROVED
A	NEW RELEASE	LL 23/06/05		

NOTES:

1. SPECIFICATIONS

- . Switch Function: Single Pole Single Throw
- . Contact Rating: 50mA at 12Vdc
- . Insulation Resistance: 100MΩ min.
- . Contact Resistance: 100mΩ max.
- . Operating Life: 100,00 cycles

- . Stop Strength: Place The Switch Such That Vertical, A Static Load Of 3Kgf Shall Be Applied In The Direction
- . Operation Temperature Range: -25°C to +70°C
- . Wave Soldering: Recommended Solder Temperature At 500°F(260°C)max. 5 Seconds, Subject To PCB 1.6mm Thickness.
- . Hand Soldering: Use Soldering Iron Of 30 Watts, Controlled At 608°F(320°C) Approximately 2 Seconds.

2. PRODUCT NUMBER CODE:

DS1109-01 - X X X X X

- Packing type  
A: polybag  
B: tube  
R: tape & reel
- Actuator color  
L: blue K: black  
N: brown R: red  
Y: yellow
- Housing color  
L: blue K: black  
N: brown R: red  
Y: yellow
- Profile Height(DIM. H)  
1: 4.3mm 2: 5.0mm 3: 7.0mm  
4: 7.3mm 5: 9.5mm 6: 13.0mm
- Size  
1: 6mm\*6mm

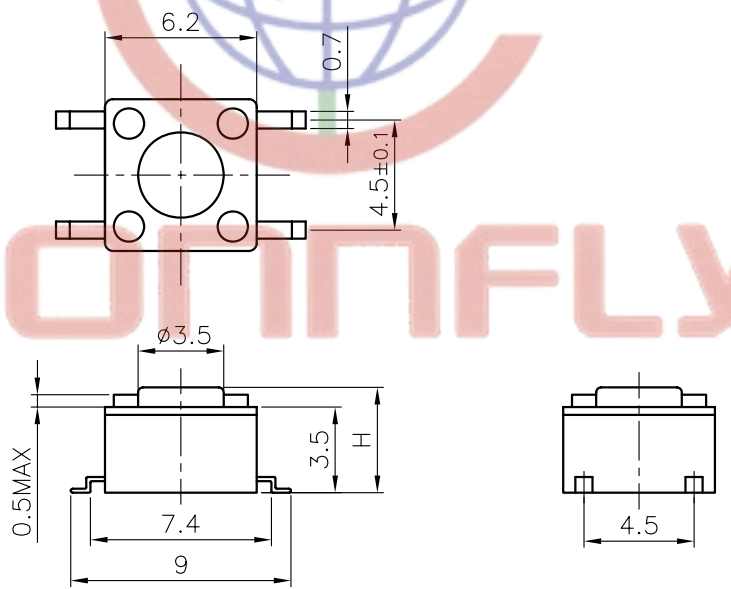

CIRCUIT DIAGRAM

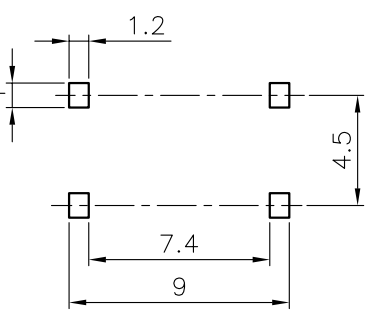
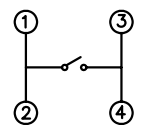

Recommend PCB layout  
Tolerance ±0.05

Tel: 86-574-63508787  
Fax: 86-574-63510817

GENERAL TOLERANCE		ANGLE TOLERANCE		PROJECTION		TITLE	TACT SWITCH SMT TYPE 6mmX6mm
X.	±0.60	X.	±5°	UNITS	mm		
.X	±0.38	.X	±3°	SHEET SIZE	A4	SERIES	DS1109-01
.XX	±0.25	.XX	±2°				
DRAWING TYPE		CUSTOMER		晨翔电子有限公司 <b>CONNFLY CONNFLY ELECTRONIC CO. LTD</b>			
SCALE		1:1 SHEET 1 OF 1					
DRAWING NO.		C-DS1109-01-1XXXX					