



**SPECIFICATIONS**

Rated Current:3.0AMP  
 Contact Resistance:20mΩ Max  
 Withstand Voltage:1000V AC/DC  
 Insulation Resistance:1000MΩ Min  
 Operation Temperature:-40°C to +105°C

Contact Material:Brass  
 Contact Plating:Au Over Ni  
 Insulator Material:Polyester(UL94V-0)  
 Standard: PA6T  
 Max.Processing Temp: 230°C for 30-60 seconds  
 (260°C for 10 seconds)

**Recommended P.C.B Layout(Top Side)**  
 (PCB BOARD TOLERANCE±0.05)

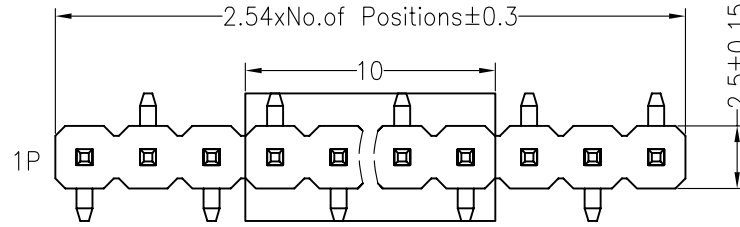

Type01

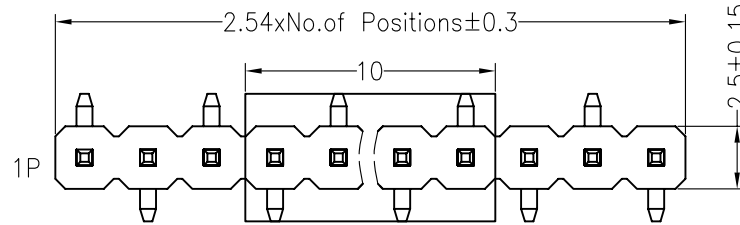
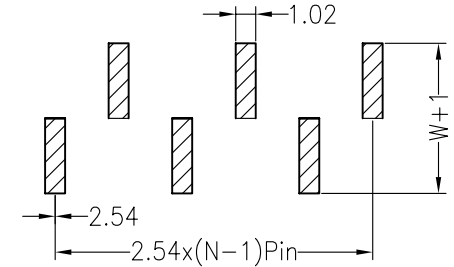

Type02

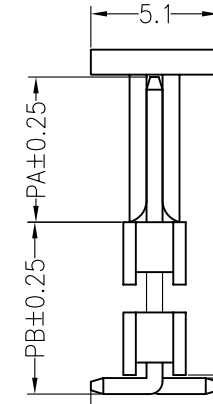
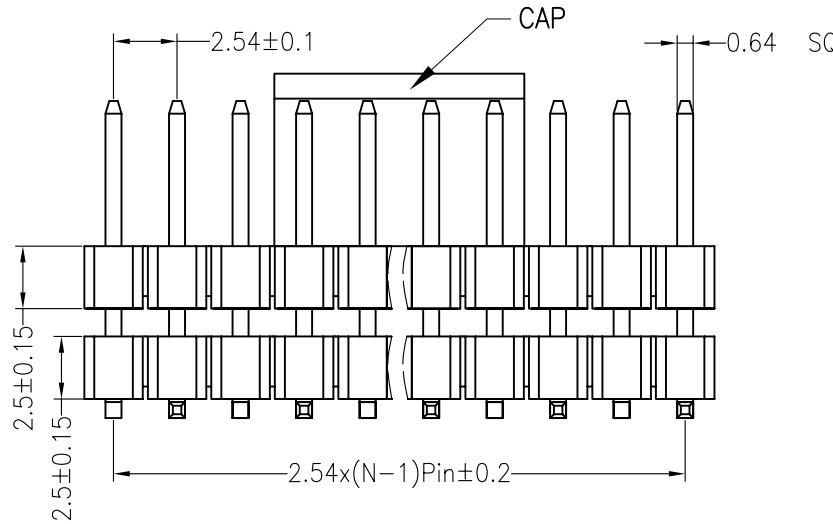
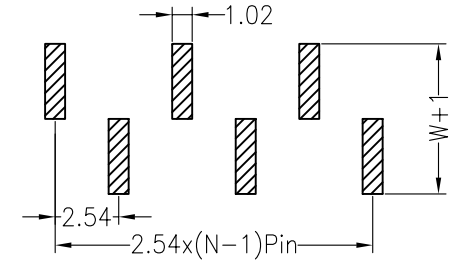

**Ordering Information**

1225 2 1 XX X N XX M XXX X 01(2)

- No. of Pins Per Row: 1\*40
- Insulator Material Option: A=BK-PBT, B=BK-PA66, C=BK-PA6T, D=BK-PA46, F=BK-LCP
- Post: W=With Post, N=W/O Post
- Contact Plating: G0:Gold Flash, G2:5U" Gold, G3:10U" Gold, G4:15U" Gold, G5:30U" Gold, S0:Gold Flash/Tin, SN:Tin
- Packing: O=PE Bag, A=Tray, T=Tube, P=Tube+Cap, R=Reel+Cap, M=Reel+Mylar

Dimension antitheses list					
ITEM	PA	D	PB	W	L
Standard	6.00	0.20	5.84	5.10	13.80
Alternate					

				OPERATION		DRAW	YiYuSheng	13.03.28	SCALE	FIT		
				X.X	±0.30				UNIT	mm		
				X.XX	±0.20	CHECK		SIZE	A4			
A0	2013.03.28	NEW DRAWING		X.XXX	±0.10	APPROVE		SHEET	1/1	PART NO.		
REV	DATE	MODIFICATION DESCRIPTION		CHANGE	DIM	TOL		PROJ.		TITLE:	2.54mm Pin Header 2.5+2.5mm SMT	